

LAND FOR SALE

SOUTHEAST SIOUX COUNTY RANGE

SOLD

View our Current Listings
[HERE!](#)

Location: Southeast Sioux County Nebraska. Nine miles north of Lake Minatare on Henderson Road, or 7 miles east of Scottsbluff and 15.5 miles north.

Legal Description: All Sec 31-T25N-R53W; All Sec 1; All Sec 2; All Sec 3; N1/2N1/2 Sec 10; N1/2N1/2 Sec 11; N1/2N1/2 Sec 12-T24-R54W of the 6th P.M., Sioux County, Nebraska

Land Use: Hardland summer range.

Acres: 3,090.90 deeded.

Taxes: 2010 Real Estate Taxes payable in 2011 - \$6,565.66 or \$2.12 per acre.

Pastures: Cross-fenced into 3 pastures and watered by 7 windmills with 25 ft. bottomless tanks. Access from county graveled Henderson Road.

Price: \$1,020,000 (\$330/acre)

Comments: Excellent pasture for yearlings or pairs.

Contact: Bruce Dodson– Listing Agent, 308-539-4455, email: bruce@agriaffiliates.com
Mike Polk– Listing Agent, 308-539-4446, email: mike@agriaffiliates.com
Loren Johnson, 308-539-4452
Jerry Sloan, 308-631-5520
Roger Luehrs, 308-631-2506



Offered Exclusively By:

NORTH PLATTE OFFICE
P.O. Box 1166
I-80 & US Hwy 83
North Platte, NE 69103
www.agriaffiliates.com

(308) 534-9240

Telecopier (308) 534-9244

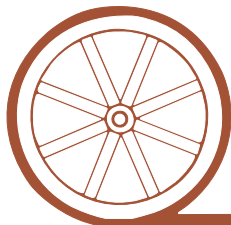

AGRI AFFILIATES, INC.

...Providing Farm - Ranch Real Estate Services...

Information contained herein was obtained from sources deemed reliable. We have no reason to doubt the accuracy, but we do not guarantee it. Prospective Buyers should verify all information, including items of income and expense. All maps provided by Agri Affiliates, Inc. are approximations only, to be used as a general guideline, and not intended as survey accurate.



SE Sioux County Range

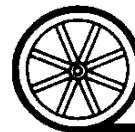
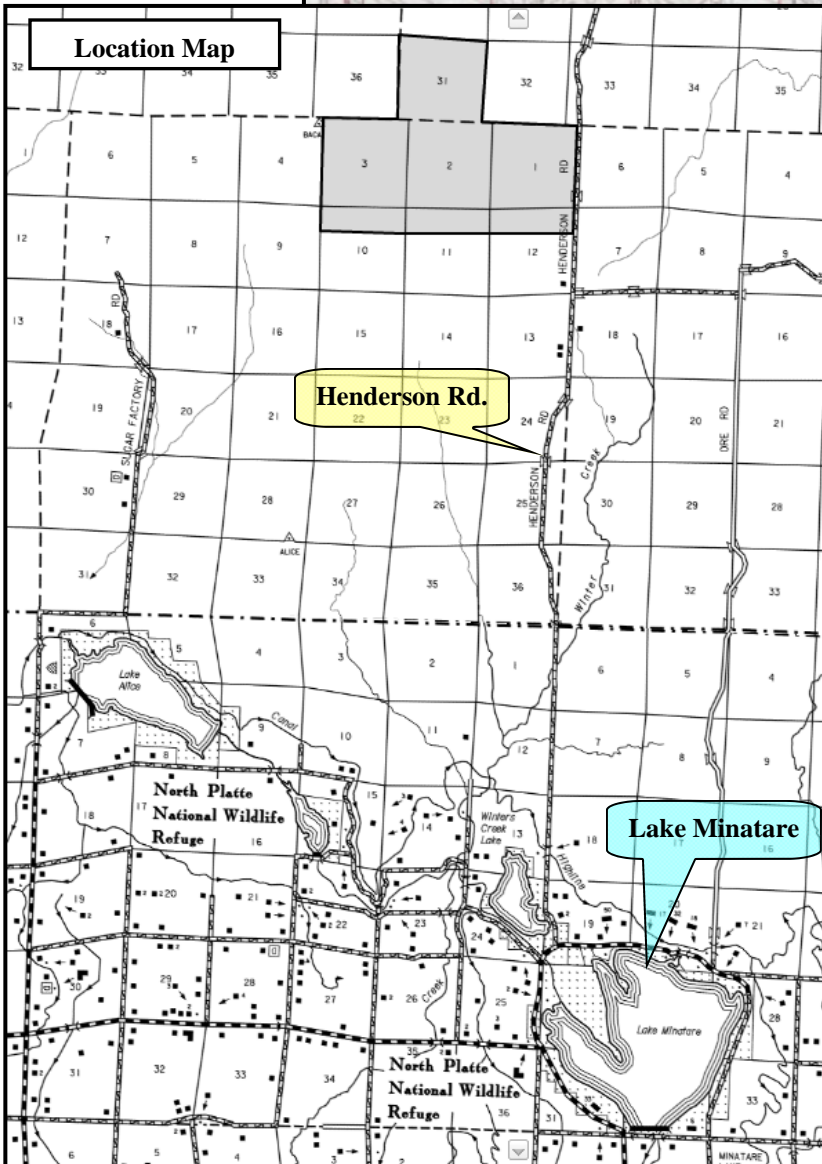
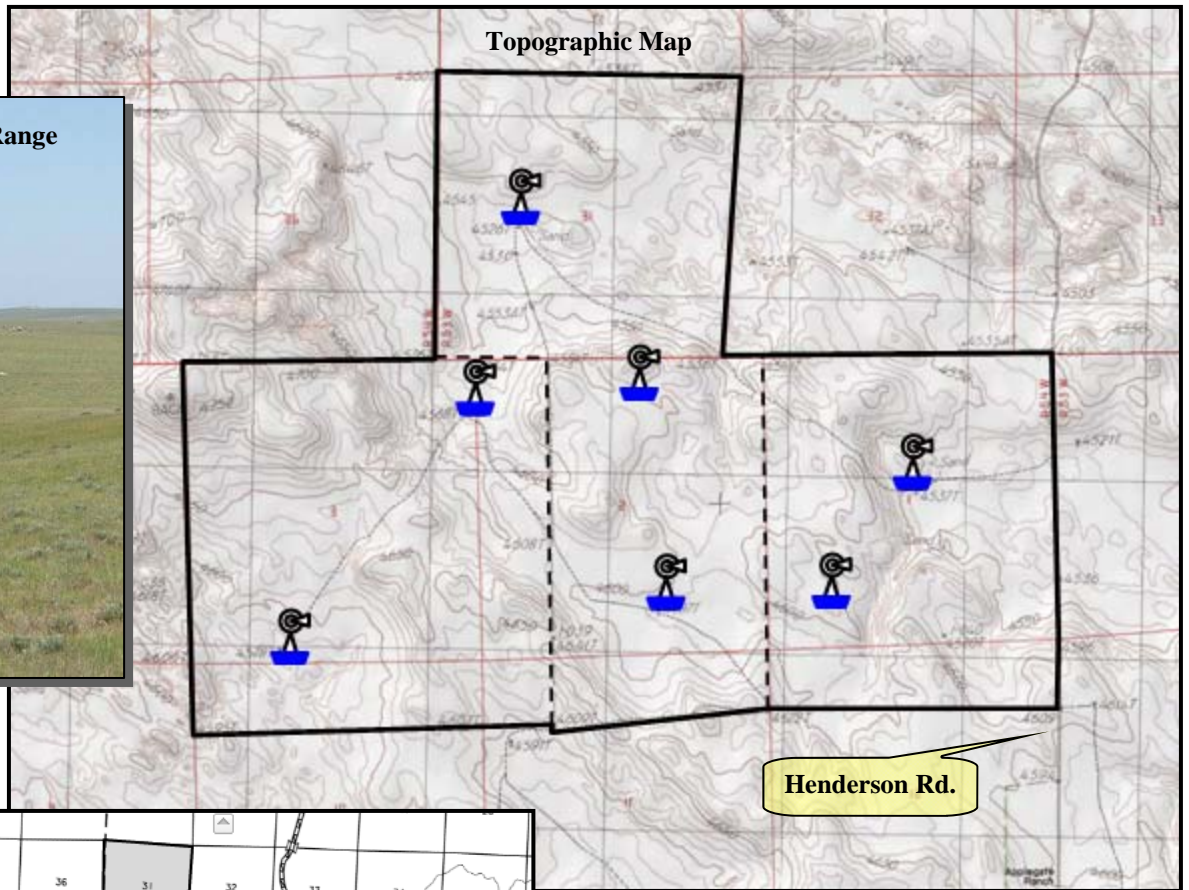

AGRI AFFILIATES, INC.

...Providing Farm - Ranch Real Estate Services...

All maps provided by Agri Affiliates, Inc. are approximations only, to be used as a general guideline, and not intended as survey accurate.